

DETALLE S24

ESC.1./2

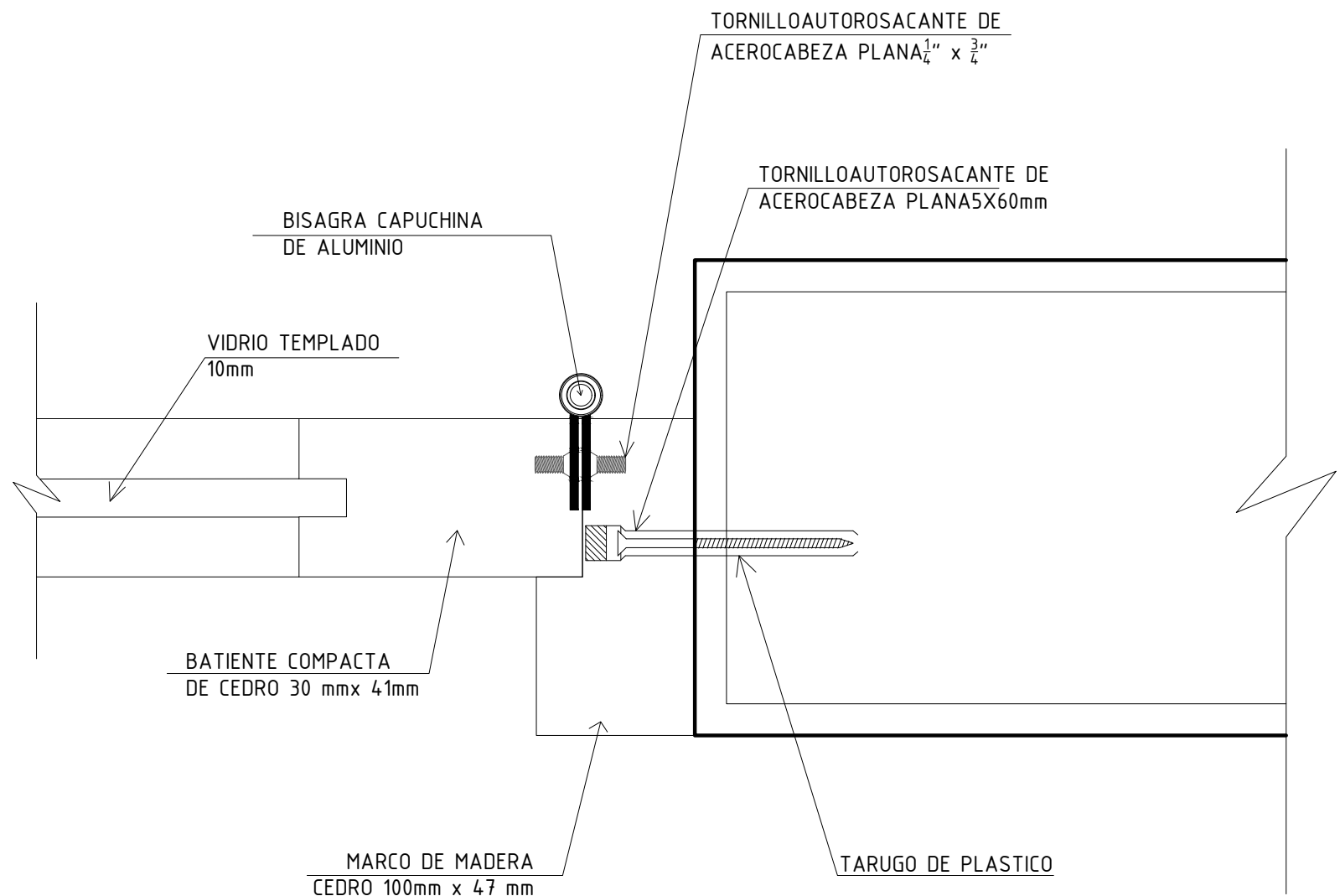

DETALLE S25

ESC.1./2

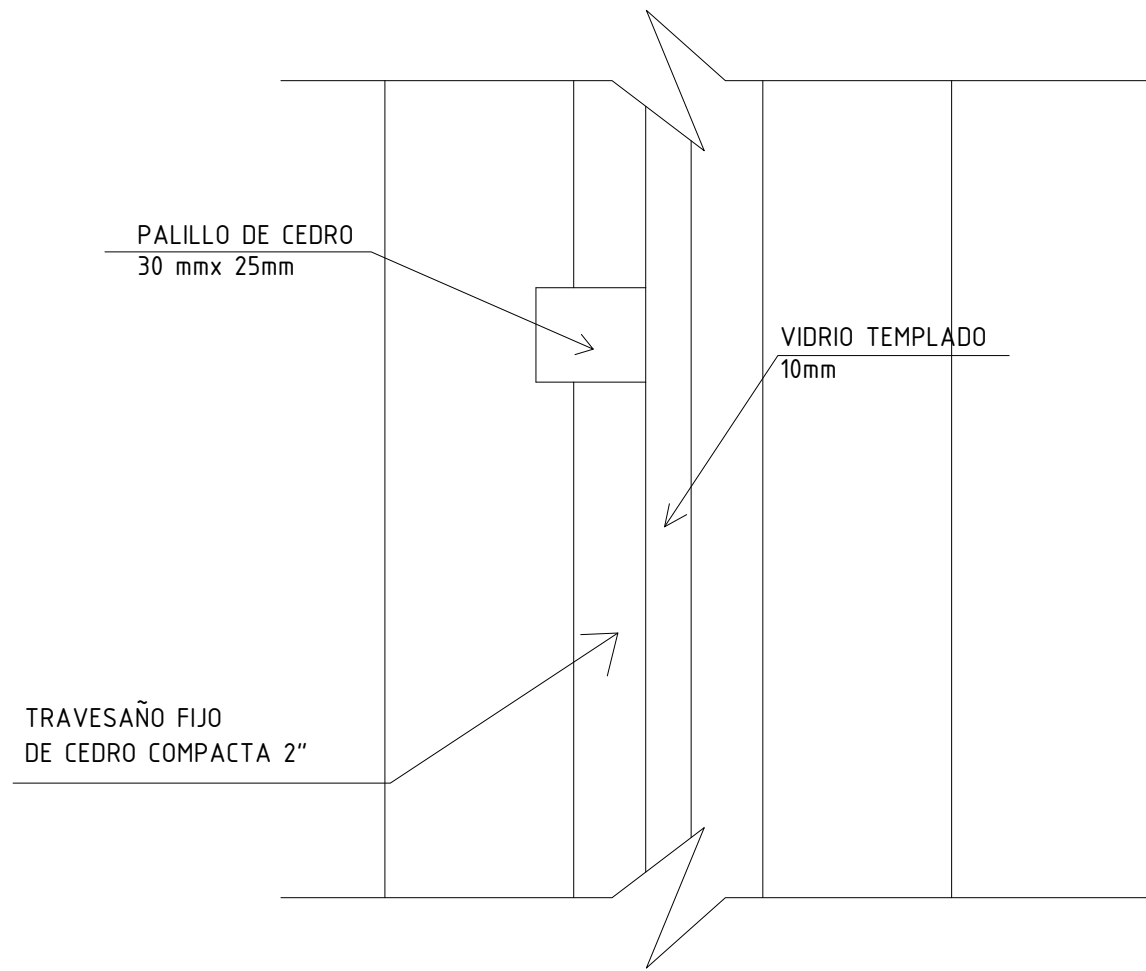

DETALLE S27

ESC.1./2

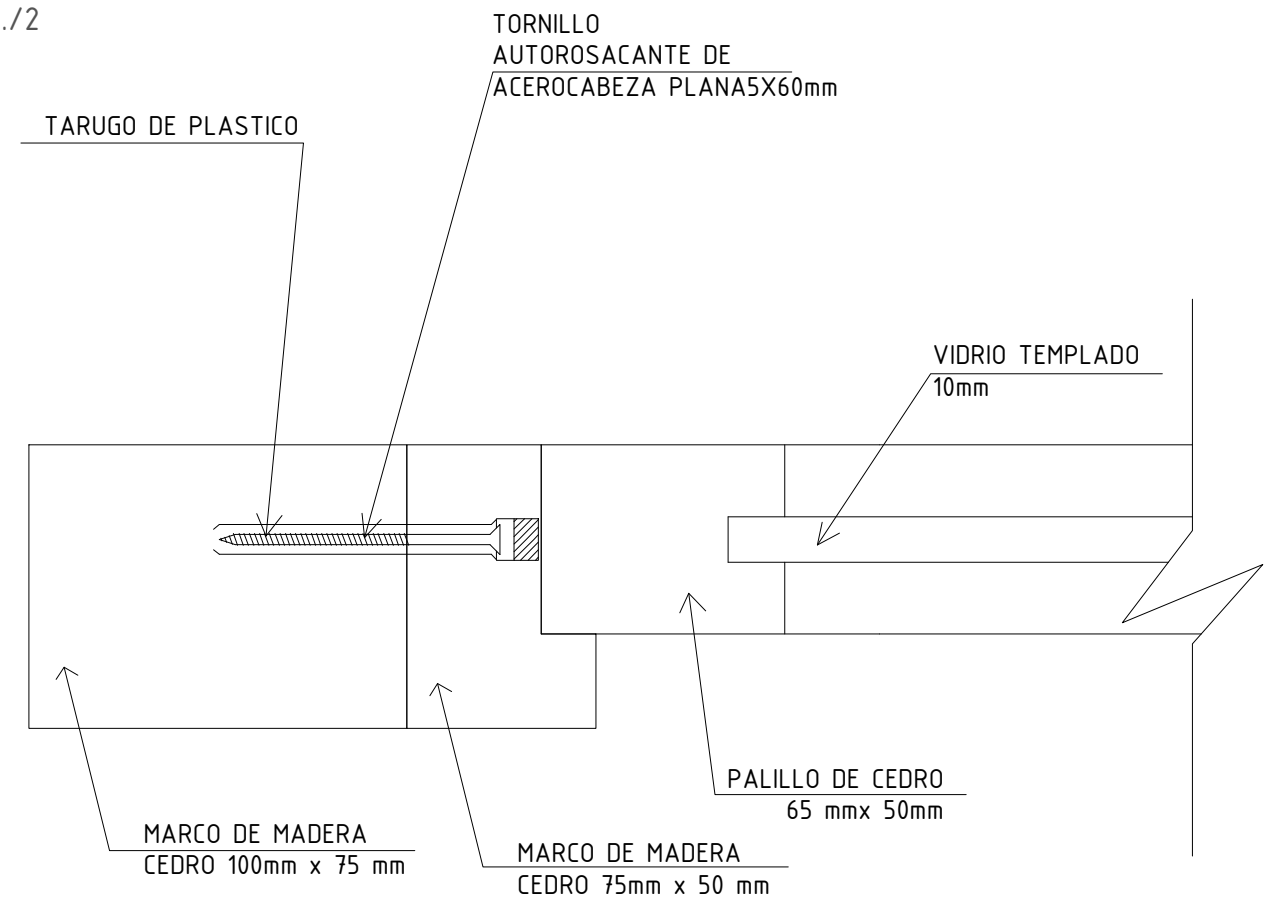

DETALLE S26

ESC.1./2

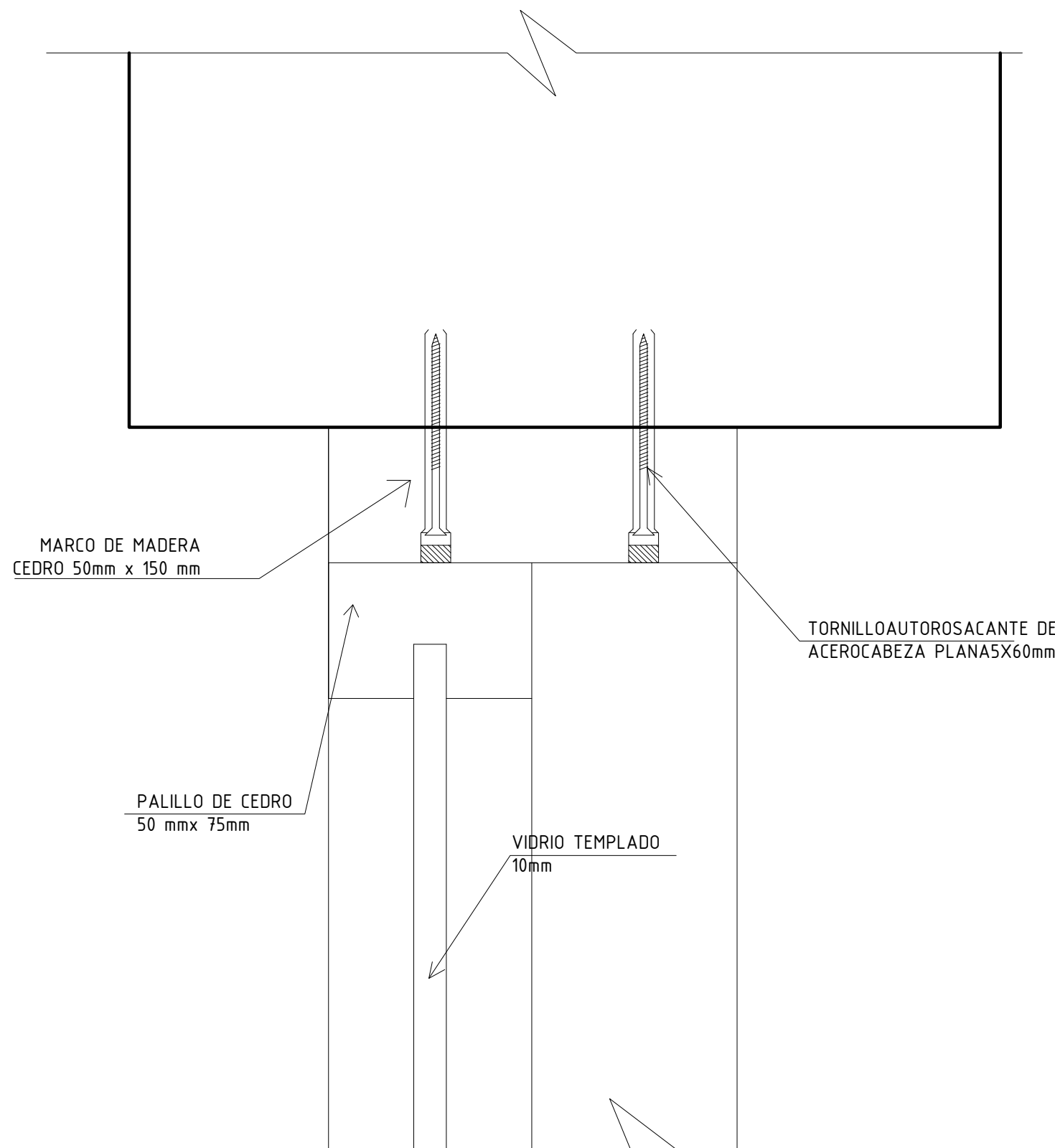

DETALLE S23

ESC.1./2

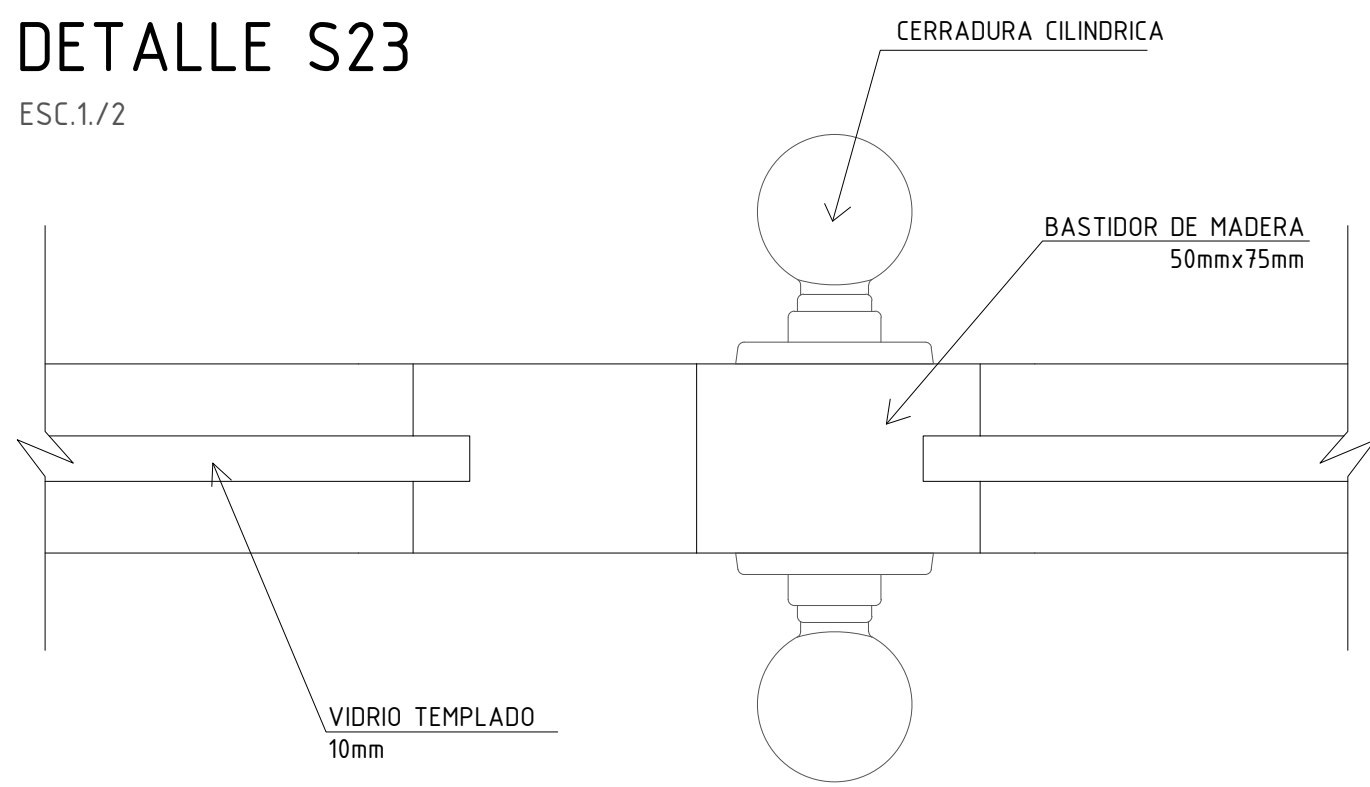

DETALLE S28

ESC.1./2

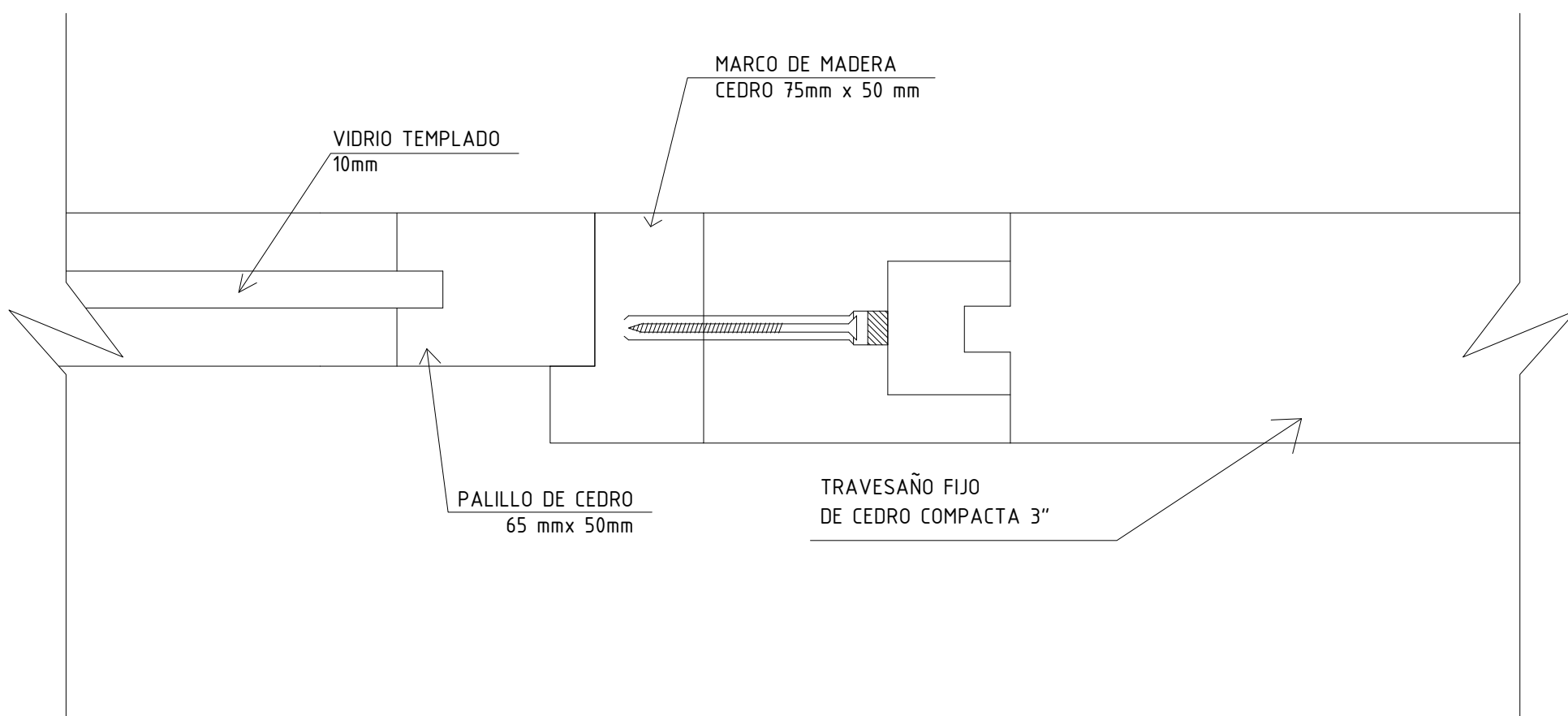

DETALLE S30

ESC.1./2

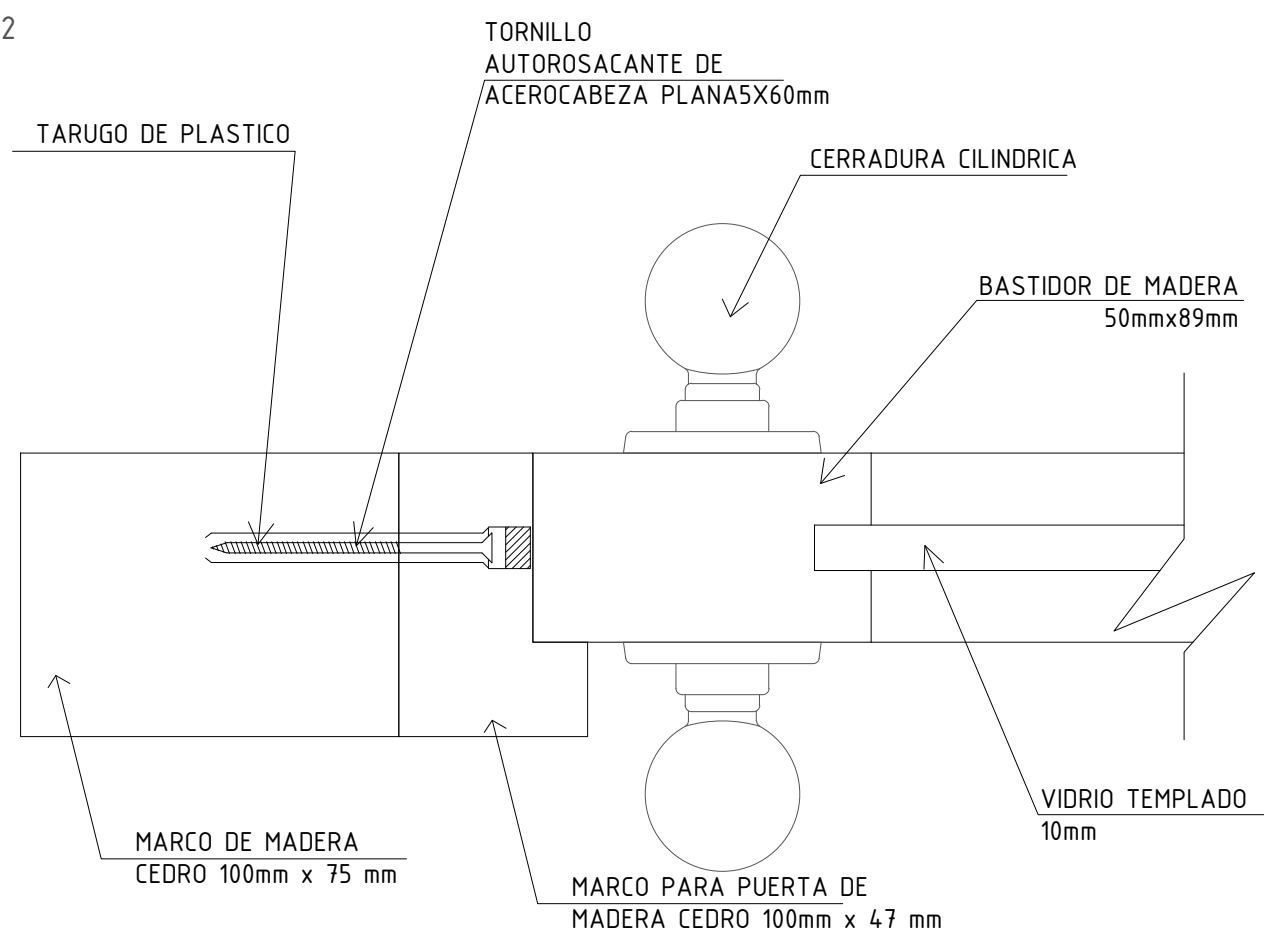

DETALLE S29

ESC.1./2

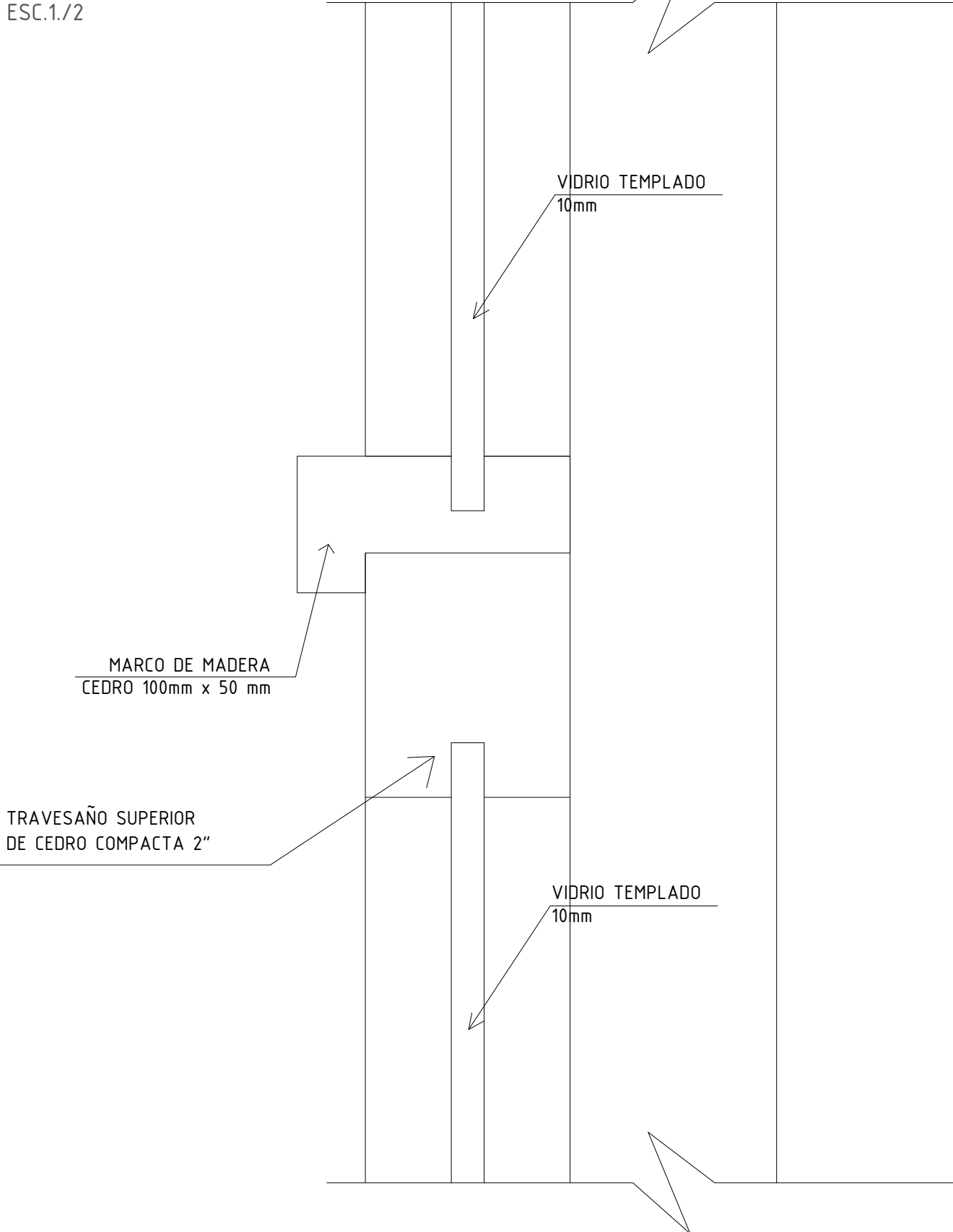

DETALLE S22

ESC.1./2

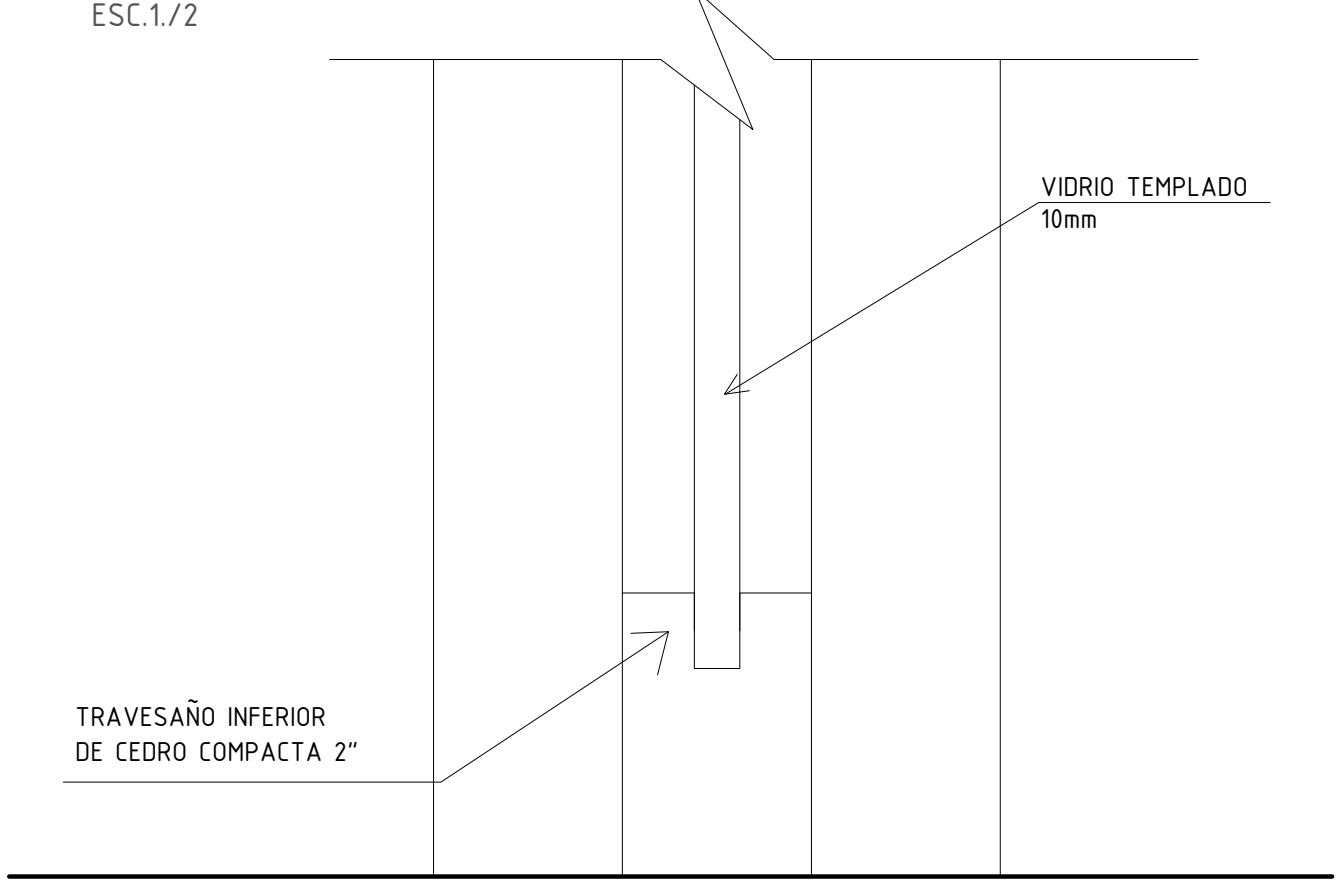

DETALLE S32

ESC.1./2

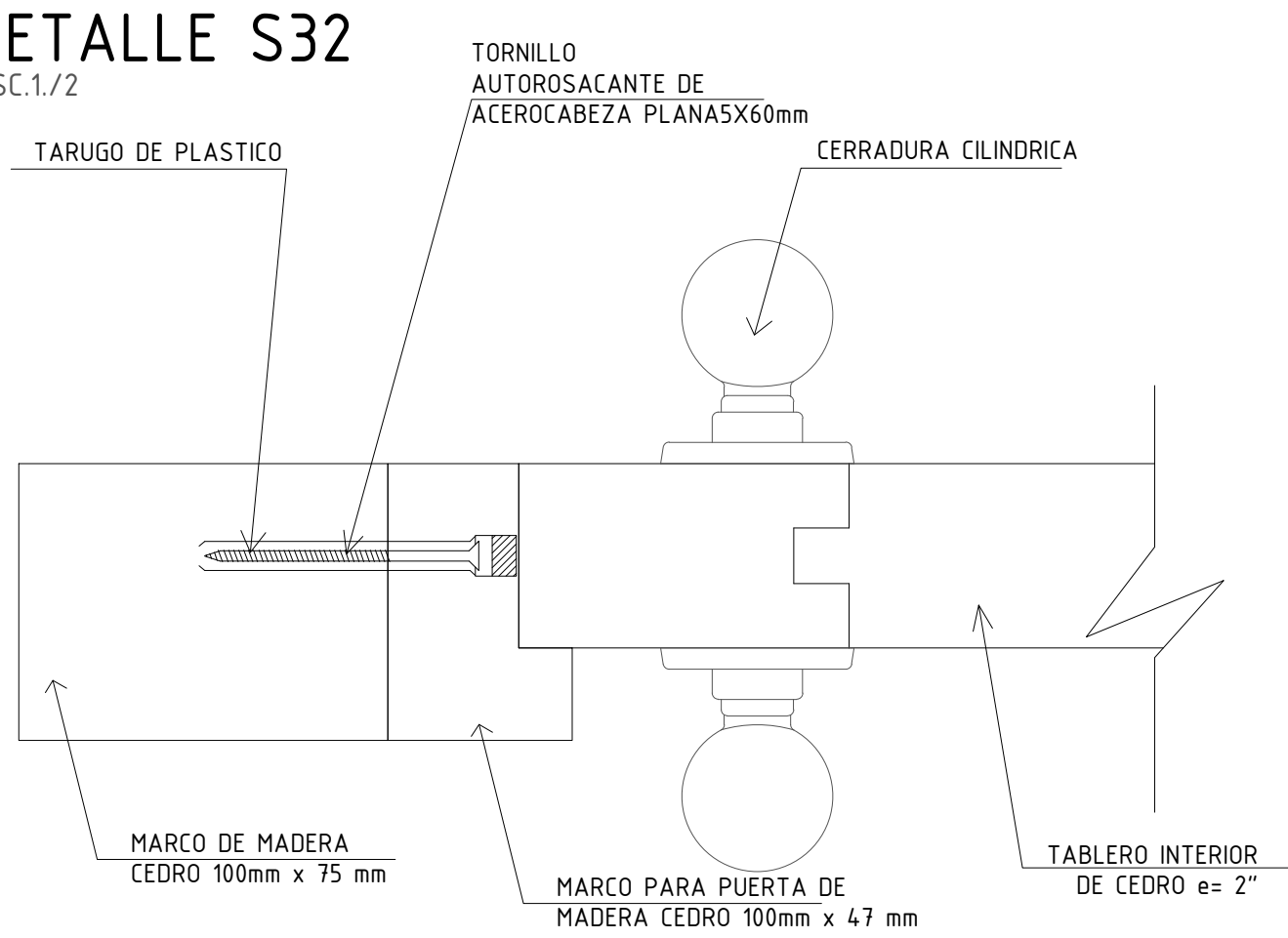

DETALLE S31

ESC.1./2

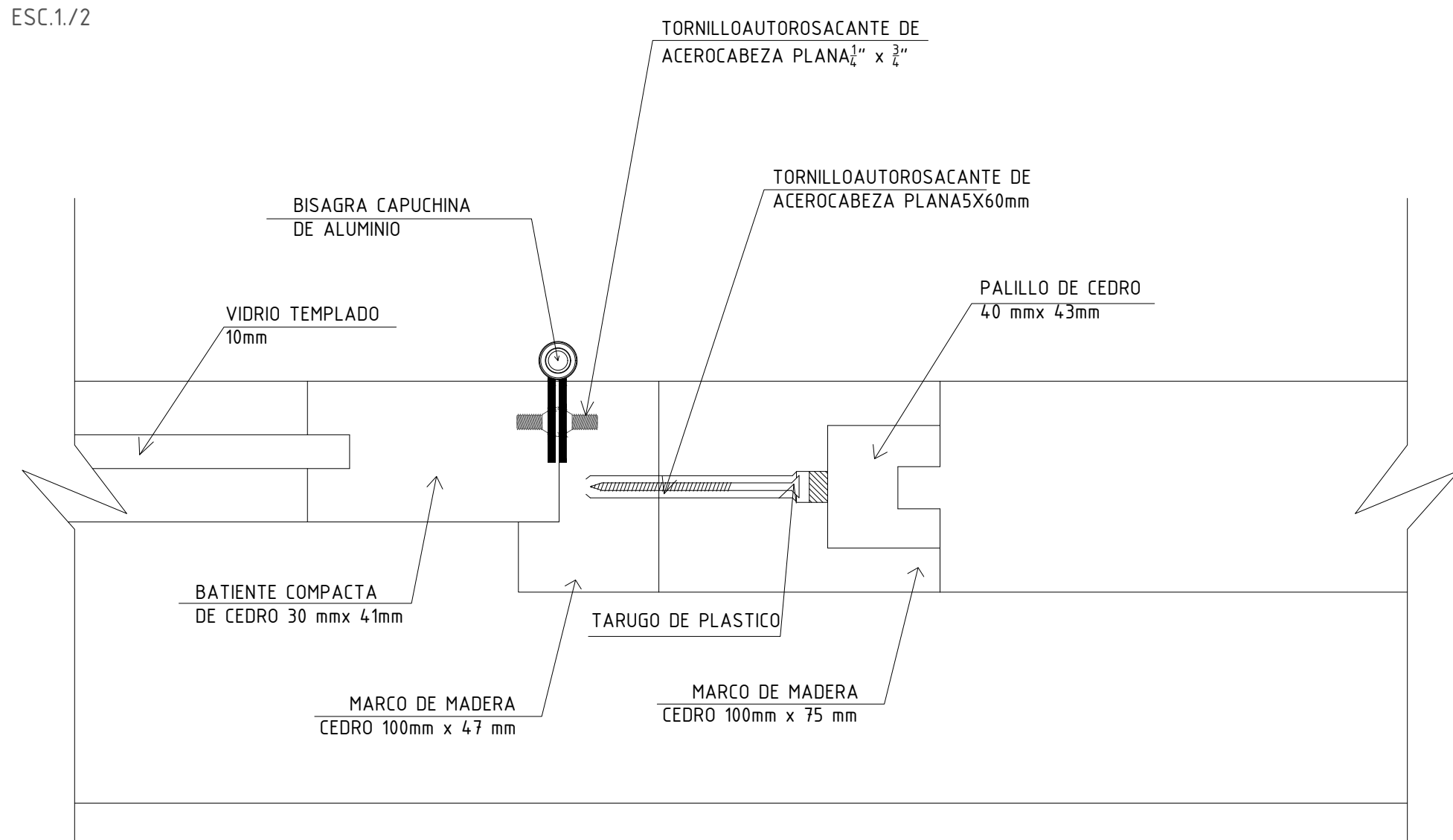

CUADRO DE VANOS

| TIPO | MEDIDAS | | OBSERVACIONES | |
|------------------|---------|--------|---------------|-----------|
| | ANCHO | ALTURA | | |
| PUERTA | P01 | 1.80 | 2.10 | Corrediza |
| | P02 | 1.00 | 2.10 | |
| | P03 | 0.90 | 2.10 | |
| | P04 | 0.65 | 2.10 | |
| | P05 | 1.20 | 2.10 | Batiente |
| | P06 | 2.05 | 2.10 | |
| | P07 | 0.70 | 2.10 | |
| | P08 | 0.60 | 2.10 | |
| VENTANAS Y VANOS | 01 | 4.30 | 0.65 | |
| | 02 | 2.15 | 1.10 | |
| | 03 | 1.85 | 2.74 | |
| | 04 | 4.30 | 2.74 | |
| | 05 | 2.25 | 2.74 | Batiente |
| | 06 | 1.30 | 2.20 | |
| | 07 | 1.70 | 2.20 | |
| | 08 | 2.50 | 2.20 | |
| | 09 | 1.00 | 2.20 | |
| | 10 | 1.70 | 2.20 | |
| | 11 | 2.65 | 2.20 | |
| | 12 | 2.00 | 2.20 | |
| PANTALLA | 13 | 1.00 | 2.20 | |
| | 14 | 1.25 | 2.20 | |
| | 15 | 1.50 | 2.75 | |
| | 16 | 2.40 | 2.20 | |
| | 17 | 1.85 | 2.20 | |
| | 18 | 2.00 | 2.20 | |
| | 19 | 1.95 | 2.20 | |
| | 20 | 1.84 | 2.20 | |
| | M01 | 4.30 | 2.75 | Corrediza |
| | M02 | 1.82 | 2.75 | Batiente |
| | M03 | 1.80 | 2.75 | Batiente |
| | M04 | 1.10 | 2.75 | Batiente |
| | M05 | 0.95 | 2.75 | Fija |
| | M06 | 1.05 | 2.75 | Fija |
| | M07 | 1.30 | 2.75 | Fija |
| | M08 | 0.90 | 2.75 | Batiente |

PROYECTO:
VIVIENDAS PRODUCTIVAS
Y PROCESADORA DE TRUCHA
HUARAZ

ALUMNA:
VELÁSQUEZ LÓPEZ MARGARITA T.

DESCRIPCION:
DETALLE DE PUERTAS
Y VENTANAS

ESCALA:
1/2

FECHA:
JULIO 2021

PROFESIONAL RESPONSABLE:
ARQ. JORGE COSMÓPOLIS BULLÓN
ING. TOMAS CARRASCO ORELLANO
ING. LUIS ALBERTO RAMOS MARTINEZ
ING. JOSE CARLOS YAFAC RISCO

LAMINA:

D-09